

THE KOLKATA MUNICIPAL CORPORATION
BUILDING DEPT.
COMPLETION PLANS
Dated: 25.03.2025
Permit No. 2020/120349
Date: 30.01.2021
By: [Signature]
By: [Signature]
A.E. (C) No. 10... E.E. (C) No. 10...

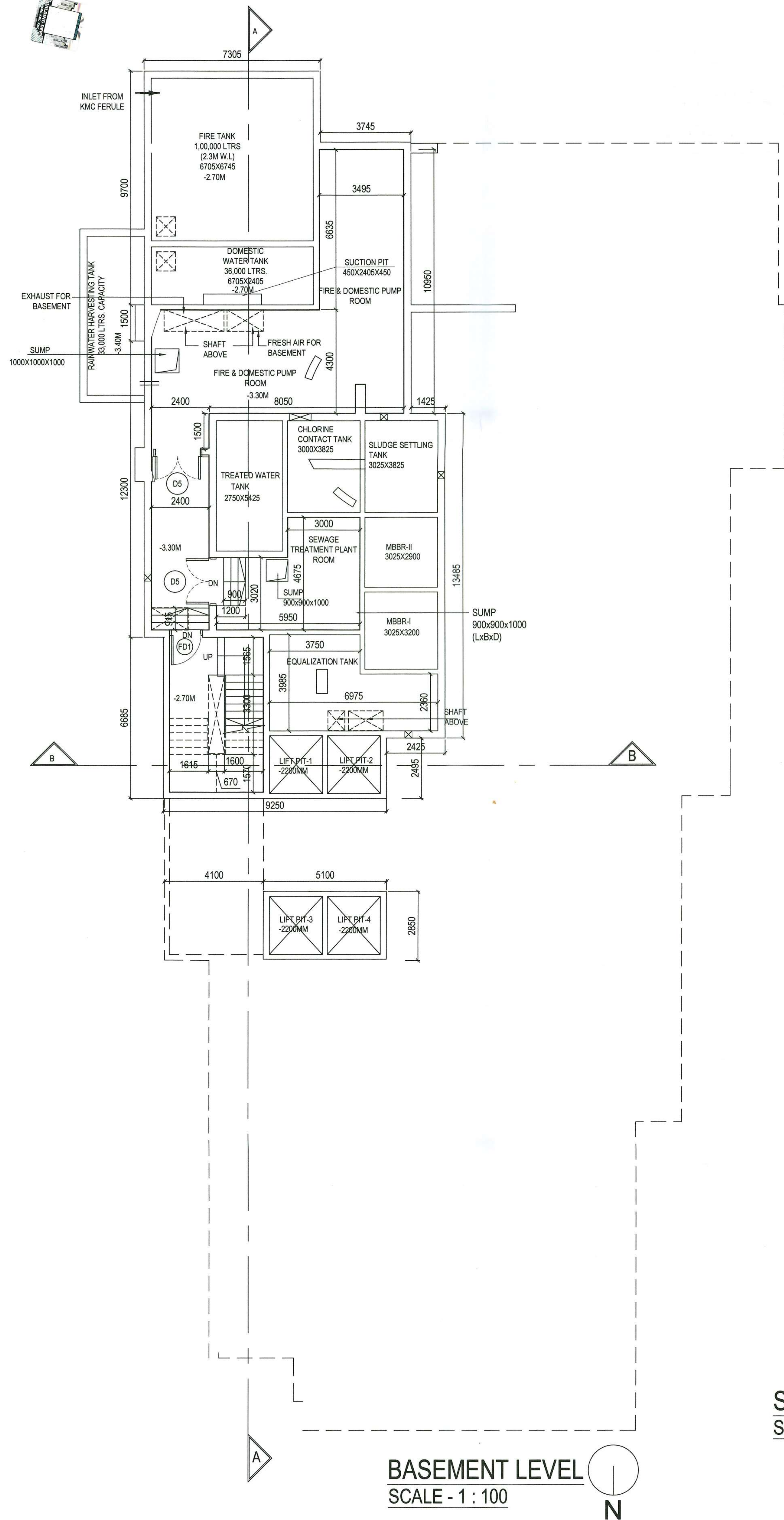

BASEMENT LEVEL
SCALE - 1 : 100

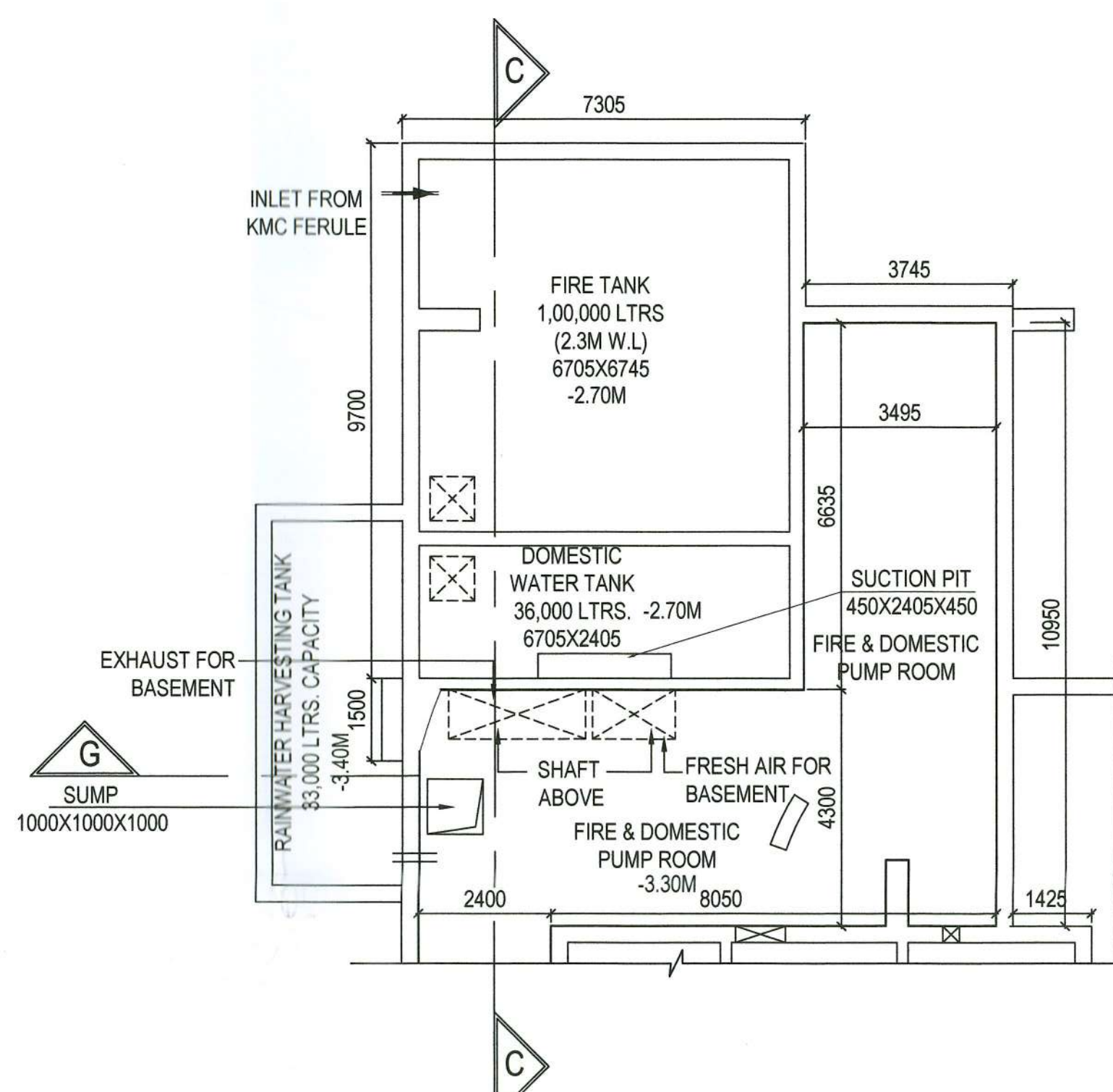

**DETAIL PLAN OF U.G.W.R FOR FIRE &
DOM. TANK , FIRE & DOM. PUMP ROOM**
SCALE - 1 : 100

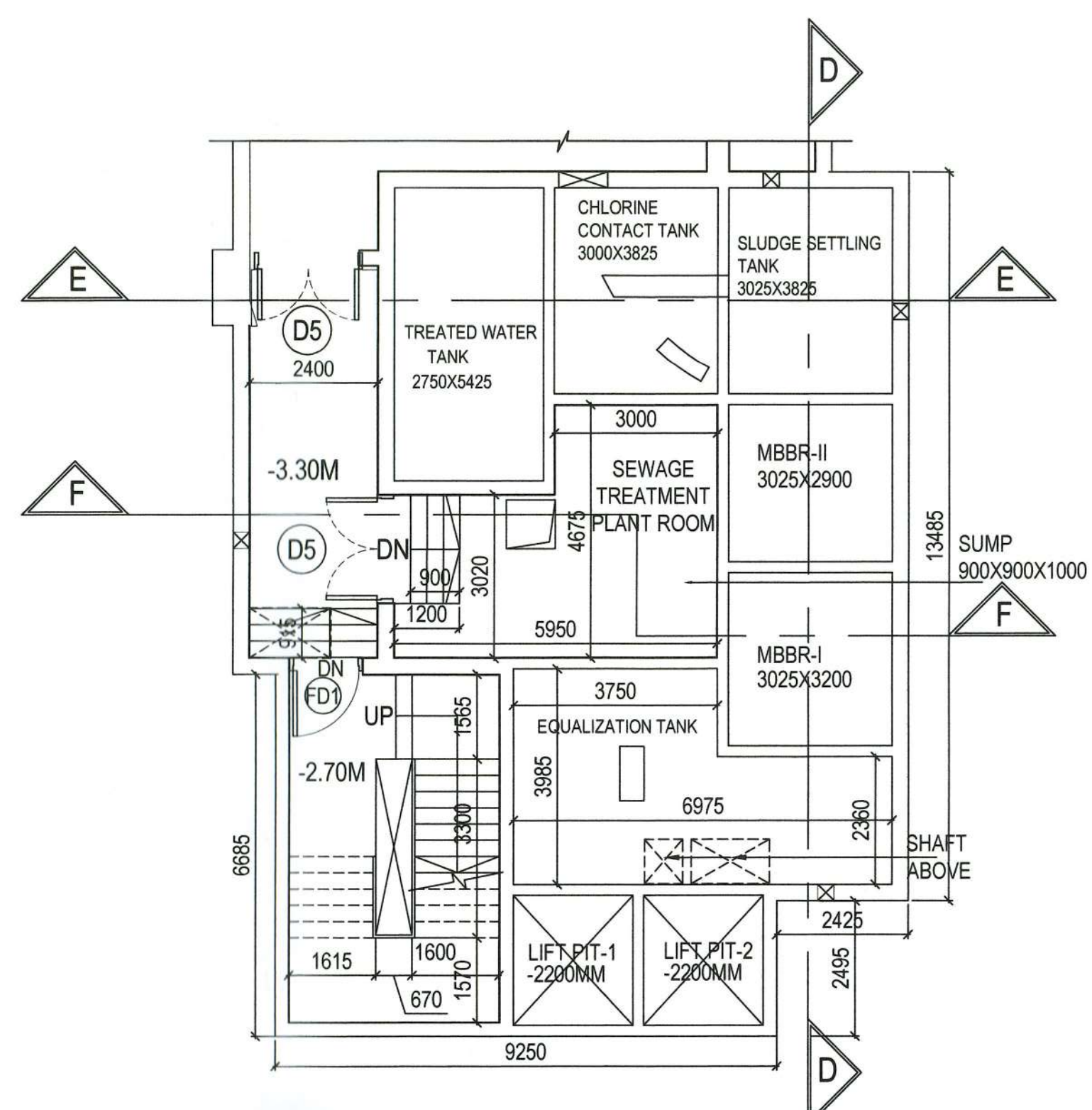

SEWAGE TREATMENT PLANT LAYOUT PLAN
SCALE - 1 : 100

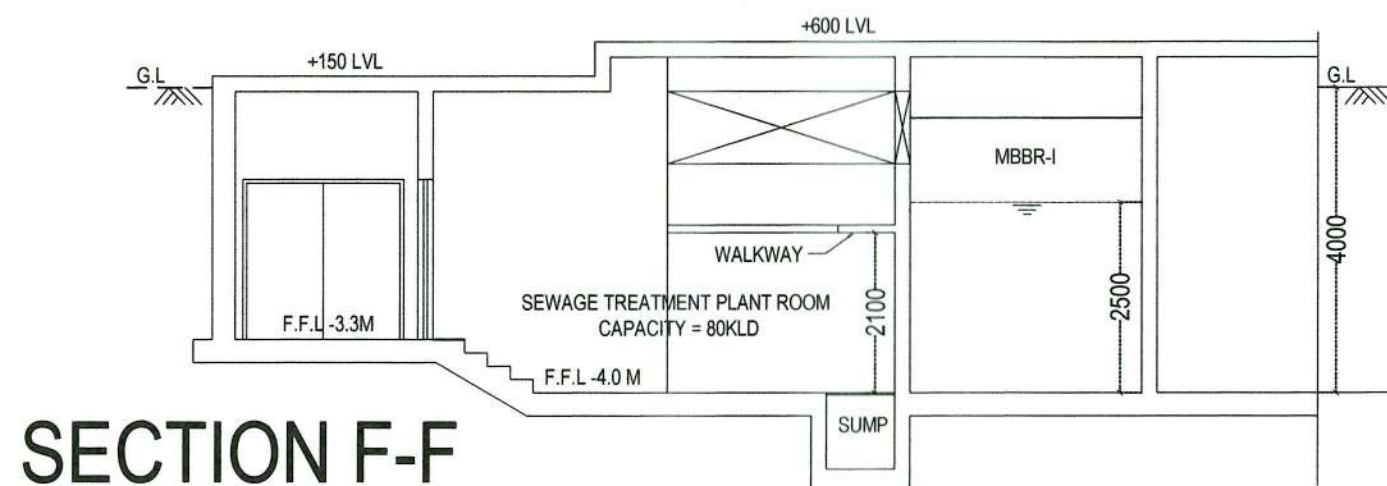

SECTION F-F
SCALE - 1 : 100

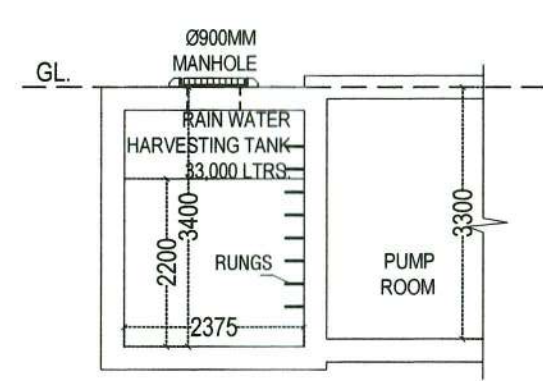

SECTION G-G
SCALE - 1 : 100

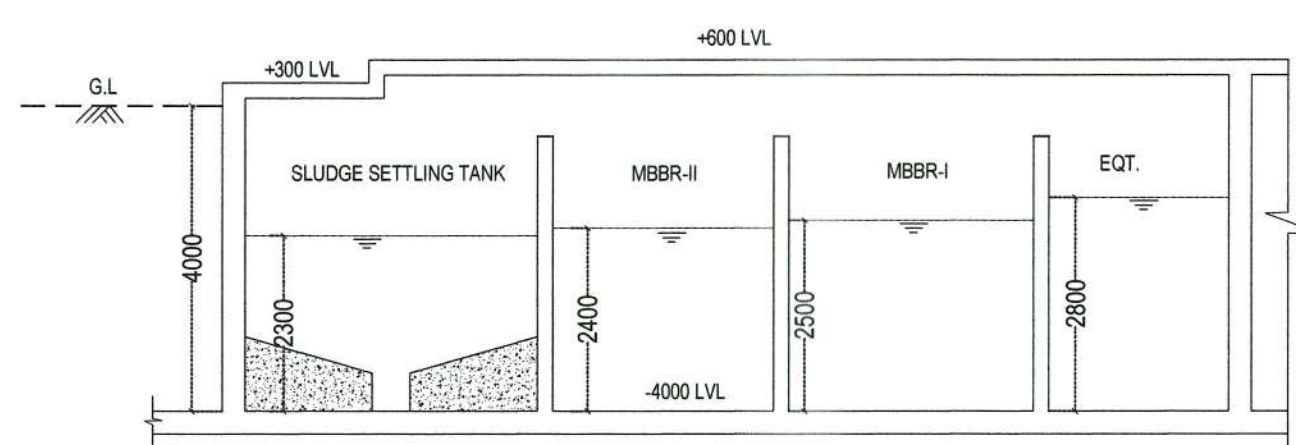

SECTION D-D
SCALE - 1 : 100

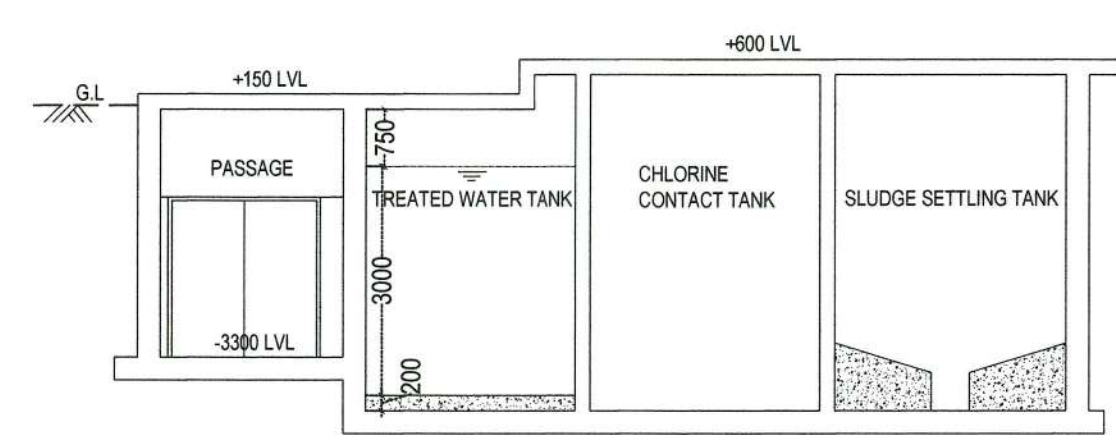

SECTION E-E
SCALE - 1 : 100

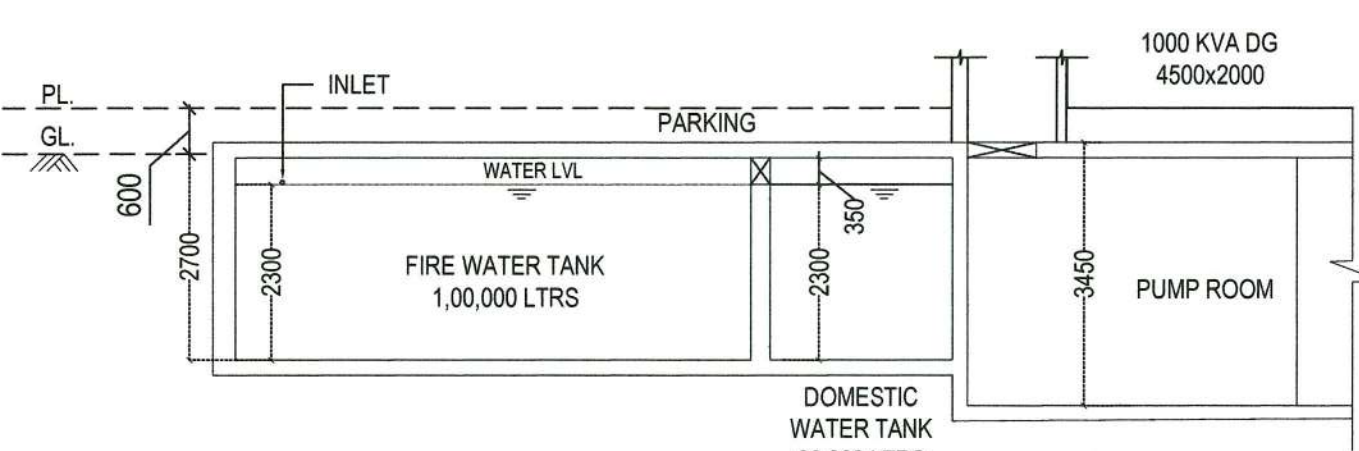

SECTION C-C
SCALE - 1 : 100

NOTES :

1. ALL DIMENSIONS ARE IN MILLIMETERS UNLESS OTHERWISE STATED.
2. ALL EXTERNAL WALLS ARE 200MM IN ALL INTERNAL WALLS ARE 150MM (75 IN).
3. THE DEPTH OF S.U.C.W.R. & SEPTIC TANK SHALL NEVER EXCEED THE DEPTH OF FORCE FOUNDATION.
4. ALL P.C.C. GRADE AS SPECIFIED BY STRUCTURAL ENGINEER.
5. ALL SORTS OF PRECAUTIONARY MEASURE WILL BE TAKEN AT THE TIME OF CONSTRUCTION.
6. OTHER ITEMS ARE AS PER I.S. SPECIFICATION.

DOOR & WINDOW SCHEDULE				
LEGEND	WIDTH	HEIGHT	SIZE	
		SILL (FROM S.S.L.)	INT'L (FROM S.S.L.)	
D1	1350	2450	1350X2450	
D1'	1350	2150	1350X2150	
D2	1200	2450	1200X2450	
D3	1200	2450	1200X2450	
D4	1200	2150	1200X2150	
D5	1200	2150	1200X2150	
D6	2000	2450	2000X2450	
D7	2000	2450	2000X2450	
D8	2000	2450	2000X2450	
D9	2000	2450	2000X2450	
D10	2000	2450	2000X2450	
D11	1350	125	1350X125	
D12	1350	125	1350X125	
D13	1350	125	1350X125	
D14	1350	125	1350X125	
D15	1350	125	1350X125	
D16	1350	125	1350X125	
D17	1350	125	1350X125	
D18	1350	125	1350X125	
D19	1350	125	1350X125	
D20	1350	125	1350X125	
D21	1350	125	1350X125	
D22	1350	125	1350X125	
D23	1350	125	1350X125	
D24	1350	125	1350X125	
D25	1350	125	1350X125	
D26	1350	125	1350X125	
D27	1350	125	1350X125	
D28	1350	125	1350X125	
D29	1350	125	1350X125	
D30	1350	125	1350X125	
D31	1350	125	1350X125	
D32	1350	125	1350X125	
D33	1350	125	1350X125	
D34	1350	125	1350X125	
D35	1350	125	1350X125	
D36	1350	125	1350X125	
D37	1350	125	1350X125	
D38	1350	125	1350X125	
D39	1350	125	1350X125	
D40	1350	125	1350X125	
D41	1350	125	1350X125	
D42	1350	125	1350X125	
D43	1350	125	1350X125	
D44	1350	125	1350X125	
D45	1350	125	1350X125	
D46	1350	125	1350X125	
D47	1350	125	1350X125	
D48	1350	125	1350X125	
D49	1350	125	1350X125	
D50	1350	125	1350X125	
D51	1350	125	1350X125	
D52	1350	125	1350X125	
D53	1350	125	1350X125	
D54	1350	125	1350X125	
D55	1350	125	1350X125	
D56	1350	125	1350X125	
D57	1350	125	1350X125	
D58	1350	125	1350X125	
D59	1350	125	1350X125	
D60	1350	125	1350X125	
D61	1350	125	1350X125	
D62	1350	125	1350X125	
D63	1350	125	1350X125	
D64	1350	125	1350X125	
D65	1350	125	1350X125	
D66	1350	125	1350X125	
D67	1350	125	1350X125	
D68	1350	125	1350X125	
D69	1350	125	1350X125	
D70	1350	125	1350X125	
D71	1350	125	1350X125	
D72	1350	125	1350X125	
D73	1350	125	1350X125	
D74	1350	125	1350X125	
D75	1350	125	1350X125	
D76	1350	125	1350X125	
D77	1350	125	1350X125	
D78	1350	125	1350X125	
D79	1350	125	1350X125	
D80	1350	125	1350X125	
D81	1350	125	1350X125	
D82	1350	125	1350X125	
D83	1350	125	1350X125	
D84	1350	125	1350X125	
D85	1350	125	1350X125	
D86	1350	125	1350X125	
D87	1350	125	1350X125	
D88	1350	125	1350X125	
D89	1350	125	1350X125	
D90	1350	125	1350X125	
D91	1350	125	1350X125	
D92	1350	125	1350X125	
D93	1350	125	1350X125	
D94	1350	125	1350X125	
D95	1350	125	1350X125	
D96	1350	125	1350X125	
D97	1350	125	1350X125	
D98	1350	125	1350X125	
D99	1350	125	1350X125	
D100	1350	125	1350X125	

UNDERSIGNED HAS INSPECTED THE SITE AND CARRIED OUT SOIL INVESTIGATION THEREON. IT IS CERTIFIED THAT THE EXISTING SOIL OF THE SITE IS ABLE TO CARRY THE LOAD COMING FROM THE PROPOSED CONSTRUCTION AND THE FOUNDATION SYSTEM PROPOSED HEREIN IS SAFE & STABLE IN ALL RESPECT FROM GEO-TECHNICAL POINT OF VIEW.

JISHU PAL
B. TECH (CIVIL), No. 01/11/32
GTE/NDA/10/094-17
HMC Reg. No. 6576/CL-11-15
JISHU PAL
GTE /1/32

SIGNATURE OF GEO. TECH. ENGINEER
WE HEREBY CERTIFY THAT THE ERECTION OF BUILDING ON PREMISES NO.183A, STREET-LASHKARHAT, WARD NO.107, BOROUGH-XII HAS BEEN SUPERVISED BY ME AND HAS BEEN COMPLETED WHOLLY ON DATED 24.12.2024, ACCORDING TO THE PLANS SANCTIONED VIDE BUILDING PERMIT NO.2020120349 DATED 30.01.2021 AND SUBSEQUENTLY REGULARISED UNDER-26(2A)(2B) VIDE MBC ITEM NO.142/24-25 DATED 19/09/2024.

THE WORK HAS BEEN COMPLETED IN ACCORDANCE WITH THE SANCTIONED PLAN AND TO OUR BEST SATISFACTION THE WORKMANSHIP AND ALL THE MATERIALS TYPE AND GRADE HAVE BEEN USED STRICTLY IN ACCORDANCE WITH GENERAL AND DETAILED SPECIFICATION AND PROVISIONS OF THE KOLKATA MUNICIPAL CORPORATION ACT 1980 AND THE KOLKATA MUNICIPAL CORPORATION BUILDING RULES 2009 HAVE BEEN VIOLATED IN COURSE OF THE WORK. THE BUILDING IS STRUCTURALLY SAFE AND FIT FOR USE FOR WHICH IT HAS BEEN ERECTED.

SANJIV J. PAREKH
BSC. FIE (F-115864-S)
REGISTERED ENGINEER
ENLISTED STRUCTURAL
REVIEWER 80416 K.M.C.
SANJIV PAREKH
ESE /1/324

SIGNATURE OF STRUCTURAL ENGINEER
SIGNATURE OF STRUCTURAL REVIEWER
WE HEREBY CERTIFY THAT THE ERECTION OF BUILDING ON PREMISES NO.183A, STREET-LASHKARHAT, WARD NO.107, BOROUGH-XII HAS BEEN SUPERVISED BY ME AND HAS BEEN COMPLETED WHOLLY ON DATED 24.12.2024, ACCORDING TO THE PLANS SANCTIONED VIDE BUILDING PERMIT NO.2020120349 DATED 30.01.2021 AND SUBSEQUENTLY REGULARISED UNDER-26(2A)(2B) VIDE MBC ITEM NO.142/24-25 DATED 19/09/2024.

THE WORK HAS BEEN COMPLETED IN ACCORDANCE WITH THE SANCTIONED PLAN AND TO OUR BEST SATISFACTION THE WORKMANSHIP AND ALL THE MATERIALS TYPE AND GRADE HAVE BEEN USED STRICTLY IN ACCORDANCE WITH GENERAL AND DETAILED SPECIFICATION AND PROVISIONS OF THE KOLKATA MUNICIPAL CORPORATION ACT 1980 AND THE KOLKATA MUNICIPAL CORPORATION BUILDING RULES 2009 HAVE BEEN VIOLATED IN COURSE OF THE WORK. THE BUILDING IS STRUCTURALLY SAFE AND FIT FOR USE FOR WHICH IT HAS BEEN ERECTED.

MANASH KUMAR SINHA ROY
Regd. No. CA/2011/54201
MANASH KUMAR SINHA ROY
CA/2011/54201

SIGNATURE OF ARCHITECT
I DO HEREBY DECLARE WITH FULL RESPONSIBILITY THAT I HAVE ENGAGED L.B.A. & E.S.E. DURING CONSTRUCTION. I HAVE FOLLOWED THE INSTRUCTION OF L.B.A. & E.S.E. DURING CONSTRUCTION OF THE BUILDING (AS PER PLAN, K.M.C. AUTHORITY) AND NOT BE RESPONSIBLE FOR STRUCTURAL STABILITY OF THE BUILDING & ADJOINING STRUCTURE. IF ANY SUBMITTED DOCUMENT ARE FOUND TO BE FAKE THE K.M.C. AUTHORITY MAY REVOKE THE SANCTION PLAN THE CONSTRUCTION OF WATER RESERVOIR AND BTP EXECUTED UNDER THE GUIDANCE OF L.B.A. & E.S.E. THE PLOT IS IDENTIFIED BY ME DURING INSPECTION.

ARUN SINGHANIA
AUTHORIZED SIGNATORY OF PRIMARK PROJECTS PVT. LTD.
C.A. FOR SHAKESPEARE PROMOTERS, PTL LTD. & OTHERS
SIGNATURE OF OWNER

TITLE :
UNDER GROUND FIRE WATER TANK, DOMESTIC WATER TANK & BASEMENT PLAN AND AREA STATEMENT

PROJECT:
COMPLETION PLAN OF A B+CHV STORED (59.8 MT HEIGHT) BUSINESS BUILDING SANCTIONED U/S 393A OF KMC ACT 1980 & KMC BUILDING RULES 2009 READ WITH RULE 69A(1) (c) OF KMC BUILDING RULES 2009 AT PREMISES NO. 183A, LASHKARHAT, WARD NO. 107, BOROUGH OFFICE - XII, UNDER K.M.C., P.S. KASBA, KOLKATA - 700039. MOUZA- LASHKARHAT, DAG NO- R.S.-391,392,393, KHATIAN NO- 193,194, 201 & 204 SANCTIONED VIDE BP NO.2020120349 DATED 30.01.2021 AND SUBSEQUENTLY REGULARISED UNDER R-26(2a)&(2b) VIDE MBC ITEM NO.142/24-25 DATED 19/09/2024

DRAWN BY :
P.H.
SCALE :
1:100
DATE :
17.12.2024
SHEET NO- :
3 OF 15
DEALT BY :
M.S.R.

PARTY'S COPY

Approved by D. G. (Building), Dt - 17.03.2025.

THE KOLKATA MUNICIPAL CORPORATION
BUILDING DEPTT.
COMPLETION PLANS
Dated: 05.03.2025
Building Permit No. 2020/20349
Floor: 30.01.2021
Through No. 20
A.E. (C) No. 50 E.E. (C) Br. No. 20
5.1.124/XII/2024-2025

Any unauthorised construction done
in deviation from the Sanction Building
permit and the Completion Plans
after issuance of this Completion
Plans may cause revocation of the
Occupancy Certificate.